



Englefield Green, Surrey

£2,750 Per calendar month

BUCKINGHAM'S



A beautifully presented semi-detached cottage located in a private cul-de-sac close to Windsor Great Park, Englefield Green. Pretty, private rear garden. Two single garages and driveway parking. Unfurnished. Council Tax Band F. EPC:59D.

Fees for tenants: Holding fee equivalent to one weeks rent, amendments to Tenancy Agreement after the document has been signed £50, change of sharer £50, stamp duty land tax (if total rent exceeds £125,000), 3% above the base rate of Bank of England per annum (calculated daily) for late/unpaid/returned rent payments, lost/damaged/broken keys/fobs or security devices at cost, deposit of five weeks rent if annual rent is less than £50,000 or six weeks rent if annual rent is £50,000 or more, all including VAT.

Wick Lane, Egham, TW20

Approximate Area = 1449 sq ft / 134.6 sq m
 Garage = 362 sq ft / 33.6 sq m
 Total = 1811 sq ft / 168.2 sq m
 For identification only - Not to scale

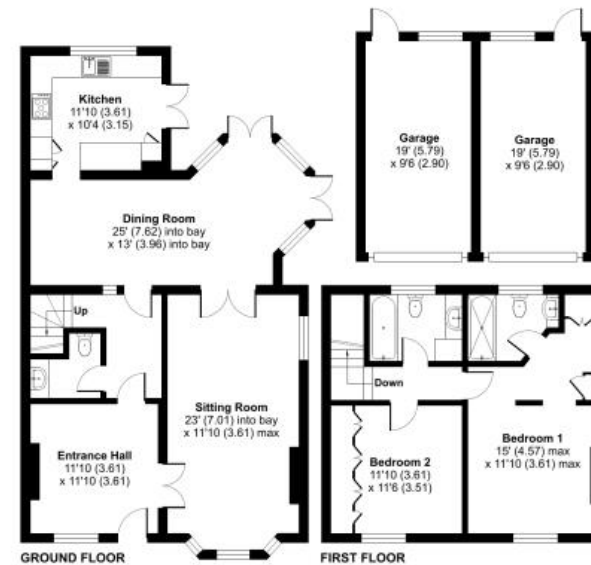

These plans produced in accordance with RICS Property Measurement Standards incorporating International Property Measurement Standards (IPMS) Residential. Produced for Buckingham. REF: 1252407

6 Station Approach Virginia Water Surrey GU25 4DL
 01344 845050
www.buckingham.com
lettings@buckingham.com



BUCKINGHAMS