



Egham, Surrey

£1,600 Per calendar month

BUCKINGHAMS



A unique and spacious one bedroom ground floor apartment situated in Luddington House, Virginia Water. Allocated parking for two vehicles, one of which incorporates a charging point for an electric or hybrid vehicle. Unfurnished. EPC:73. Council Tax Band D.

Fees for tenants: Holding fee equivalent to one weeks rent, amendments to Tenancy Agreement after the document has been signed £50, change of sharer £50, stamp duty land tax (if total rent exceeds £125,000), 3% above the base rate of Bank of England per annum (calculated daily) for late/unpaid/returned rent payments, lost/damaged/broken keys/fobs or security devices at cost, deposit of five weeks rent if annual rent is less than £50,000 or six weeks rent if annual rent is £50,000 or more, all including VAT.

Stroude Road, Egham, TW20

Approximate Area = 657 sq ft / 61 sq m

For identification only - Not to scale

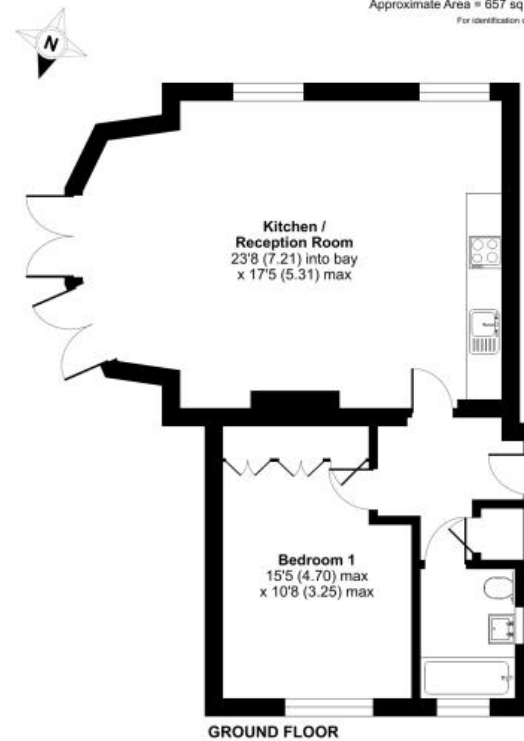

Floor plan produced in accordance with RICS Property Measurement 2nd Edition, Incorporating International Property Measurement Standards (IPMS Residential). © midwacm 2023. Produced for Buckingham's. REF: 126662

6 Station Approach Virginia Water Surrey GU25 4DL

01344 845050

www.buckingham.com

lettings@buckingham.com

onTheMarket.com

BUCKINGHAMS